

# PU2MLP Underwater LED Light

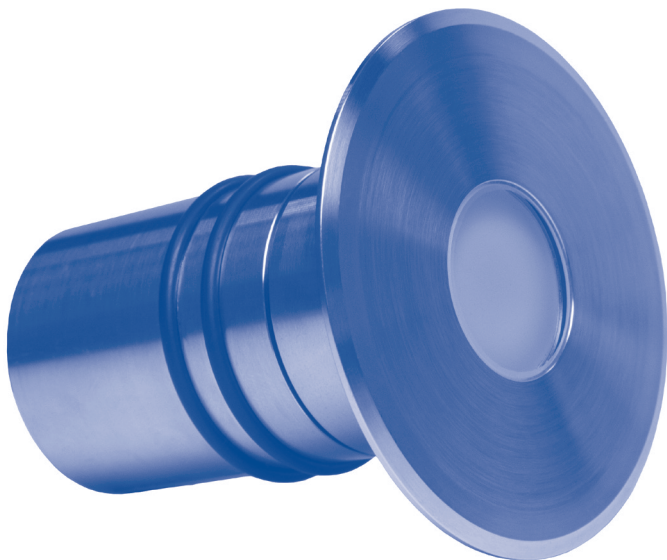

## IMPORTANT:

READ CAREFULLY BEFORE USE. KEEP FOR FUTURE REFERENCE.

### Notice to Installer:

The information within this document must be read before the installation and start-up of this product. **Once the product has been installed this document must be given to the owner/operator of this equipment.**



# Product Conformity Information:

This product complies with the following directives:

2014/30/EU: EMC Directive:

- EN55015:2013/A1:2015
- EN61547:2009
- EN61000-3-2:2014
- EN61000-3-3:2013

2011/65/EU: RoHS Directive

- IEC 62321-4:2013+AMD1:2017
- IEC 62321-5:2013
- IEC 62321-6:2015
- IEC 62321-7-1:2015
- IEC 62321-7-2:2017
- IEC 62321-8:2017

## Safety Notices:

**TO AVOID POSSIBLE HARM, READ AND FOLLOW THESE INSTRUCTIONS**



This notice signifies a hazard with a **HIGH** level of risk which, if not avoided, **WILL** result in death or serious injury.



This notice signifies a hazard with a **MEDIUM** level of risk which, if not avoided, **COULD** result in death or serious injury.



This notice signifies an **ELECTRICAL** hazard with a **HIGH** level of risk which, if not avoided, **WILL** result in death or serious injury.



This notice signifies An **ELECTRICAL** hazard with a **MEDIUM** level of risk which, if not avoided, **COULD** result in death or serious injury.



This notice signifies a hazard with a **LOW** level of risk which, if not avoided, **COULD** result in minor or moderate injury.



This notice signifies a potential risk of damage to the product or property.

### **WARNING**

This equipment must be installed by qualified persons only. Improper installation can create electrical hazards which could result in property damage, serious injury or death. Improper installation and servicing will void the warranty.

### **WARNING**

A qualified electrician must carry out all electrical wiring in accordance with local electrical regulations.

### **NOTICE**

Do not operate the light in a 'non-wet' environment for long periods.

# About The Product:

The PU2MLP Mini LED Light is a full colour changing or mono-colour (RGBW) light. It offers the flexibility to allow a choice of colours and shades, create programmable lighting sequences and to be dimmable.

It can be used as a stand alone light, or in multiples.

This product is specifically designed for use as an underwater swimming pool light. The light is IP68 rated making it suitable for permanent immersion in water.

This product is a Class III electric apparatus – it is designed to be powered by a SELV (Safety Extra Low Voltage) power source.

## WARNING

A qualified electrician must carry out all electrical wiring in accordance with local electrical regulations.

The design of the light makes it suitable for a push fit application into common 1½” piping, leaving just the fascia of the light visible on the swimming pool wall.

This product is designed to be operated and controlled by a separate Wi-Fi and Driver unit.

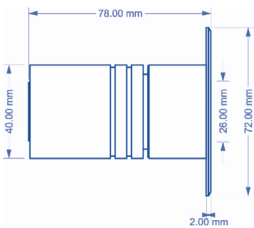
Technical Specification	
Model	PU2MLP (manufacturers item MS-UW-IRGB-A)
Rated Power	12W
Drive Mode	External Constant Current Driver (Model: R4-CC)
Drive Current	RGB: 700mA, RGBW: 350mA
Control	WIFI 104
Product Dimension	
Lens Angle	65°
Weight	0.7kg
Light Source	White/RGB/RGBW
Lumen	White: 1750-2000lm, RGB: 450-500lm
CRI	Ra>85
Max. Life Time	50,000H
Housing Material	316 Stainless Steel
Cover Material	Tempered Glass
Working Temperature	-20°C ~ 50°C
IP Grade	IP68
Mounting Type	Recessed, to suit 1.5” (43mm ID) pipe

## **WARNING**

This product contains no serviceable or changeable parts. Do not attempt to open the light housing. Opening the light housing will void all warranty.



Once expired, this product should not be disposed of via general waste, but through a regulated waste disposal and recycling centre – please consult your local authority for full advice.

## List of Supplied Components:

- PU2 LED Light incl 20m cable pre-wired
- Information for use document

## Installation:

### **WARNING**

This equipment must be installed by qualified persons only. Improper installation can create electrical hazards which could result in property damage, serious injury or death. Improper installation and servicing will void the warranty.

### **WARNING**

A qualified electrician must carry out all electrical wiring in accordance with local electrical regulations.

This light is designed to be inserted into 1 1/2" pipe which has been cut flush and sealed at the pool wall face. It is recommended that the receiving pipe/s be situated between 400-700mm below water level.

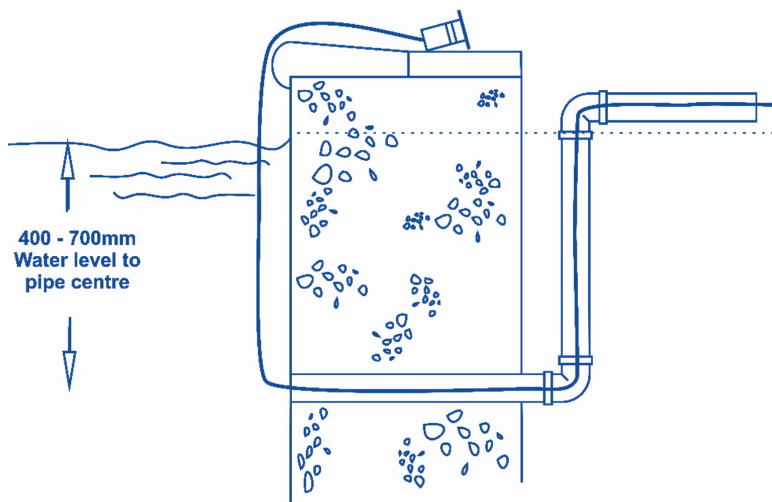

The receiving pipe should be extended/converted to conduit which then runs **above** the water level to create a run for the cable to the central control/power point.

When the light cable is fed through the receiving pipe/conduit, sufficient cable should remain free within the pipe in order to be able to remove the light unit to the pool surround.

Run the cable through the pipe/conduit back to the desired control/power point.

Coil the free cable into the pipe and insert the light body – the o-rings around the light will create a friction fit.

Multiple lights can be installed within a single pool.

Each light requires its own R4-CC driver unit (supplied separately) but multiples can be powered and controlled by a single power supply and Wi-Fi 104 receiver/transmitter (supplied separately).

The following control items are recommended and available from Certikin:

PU2MLPS	Power Supply 24v 320w
PU2MLWC	Wi-Fi 104 Controller
PU2MLRC	R4-CC Driver Receiving Controller
PU2MLE	Wall Mounted ABS Enclosure For Power Supply

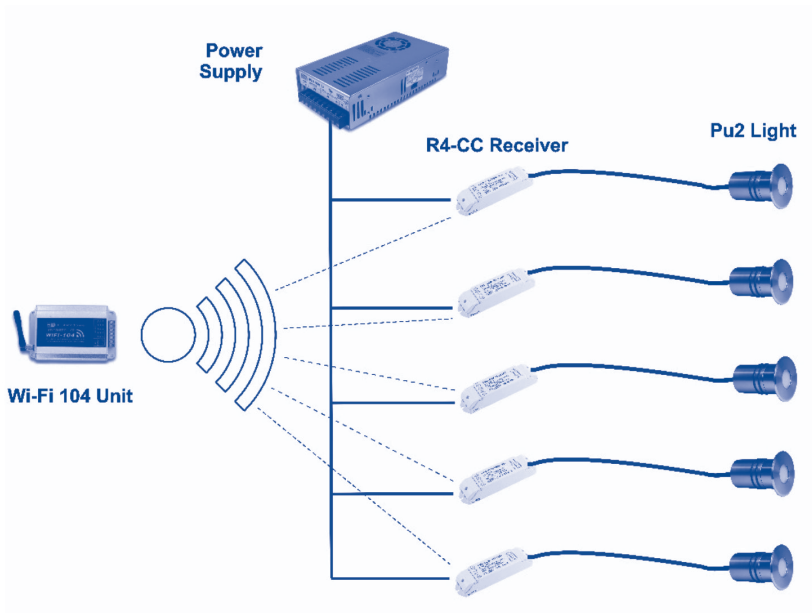

**⚠ WARNING**

Refer to and follow in the installation and operation instructions of each individual component.

## Operation:

The light is operated via the control unit and/or App provided with the Wi-Fi 104 unit. Please refer to these instructions for operational procedures relating to the light.

## Maintenance:

### NOTICE

This product contains no serviceable or changeable parts. Do not attempt to open the light housing. Opening the light housing will void all warranty.

## Troubleshooting:

SYMPTOM	POSSIBLE CAUSE	POSSIBLE SOLUTION
Light does not operate	No power to the light	Refer to qualified electrician to check wiring and power supply
	Lack of control signal	Refer to Wi-Fi 104 instructions
Failure of single light within bank of lights	Failure of single R4-CC driver	Refer back to installer/qualified electrician – interchange alternative light and test if working/test non-illuminating light with alternative driver to test if working. Replace driver if appropriate.
	Failure of single light	Refer back to installer/qualified electrician – interchange alternative light and test if working/test non-illuminating light with alternative driver to test if working. Replace light if appropriate.

[illegible]

## Manufactured By:

Maysee Technology Ltd, China

## Imported By:

Certikin International Ltd

Witan Park

Station Lane Industrial Estate

Witney

Oxfordshire

OX28 4FJ

 01993 777200  [info@certikin.co.uk](mailto:info@certikin.co.uk)

[www.certikin.co.uk](http://www.certikin.co.uk)

APRIL 2019

**Certikin**  
FLUIDRA